

## **PUBLIC ART CREATIVE OPPORTUNITY**

### **BRIEF FOR DESIGN SUBMISSIONS – COONAMBLE CBD PUBLIC AMENITIES**

Coonamble Shire Council is calling for expressions of interest (EOI) and creative submissions for the design and artwork of a new public amenities building and its surrounds. The amenities building will be located on the currently vacant block at 79 Castlereagh Street, Coonamble.

There is scope to make suggestions for public art opportunities on the external walls of the amenities building (three sides will be clearly visible) and neighbouring wall, and for the landscaping of the site. EOIs and creative submissions can incorporate one or all components, being the amenities building, wall, and surrounds.

The external of the amenities building is entirely customisable by way of photo film wrap produced from photographs, designs or images supplied. Additionally, the building may be painted once on-site.

The wall behind the building should be complementary to the artwork on the building. It may be painted or used as a blank canvas to display panels with customisable artwork.

EOIs and creative submissions can be made in any form appropriate to the concept and must be received by Council are invited to be received by Council before 5.00 p.m. on Monday 20 July 2020 to:

- The General Manager  
Coonamble Shire Council  
PO Box 249 COONAMBLE NSW 2829
- the Coonamble Shire Council Office at 80 Castlereagh Street, COONAMBLE NSW 2829,
- or [council@coonambleshire.nsw.gov.au](mailto:council@coonambleshire.nsw.gov.au).

A technical panel of appropriate community and sector representatives will be appointed to consider all submissions and provide Council with a short list of recommendations for final artwork and design of the site.

Building and site plans and site images are available on Council's website and upon request. Questions about this Brief for Design Submissions should be directed to [council@coonambleshire.nsw.gov.au](mailto:council@coonambleshire.nsw.gov.au) or 02 68227 1900.

# SITE AND BUILDING PLANS

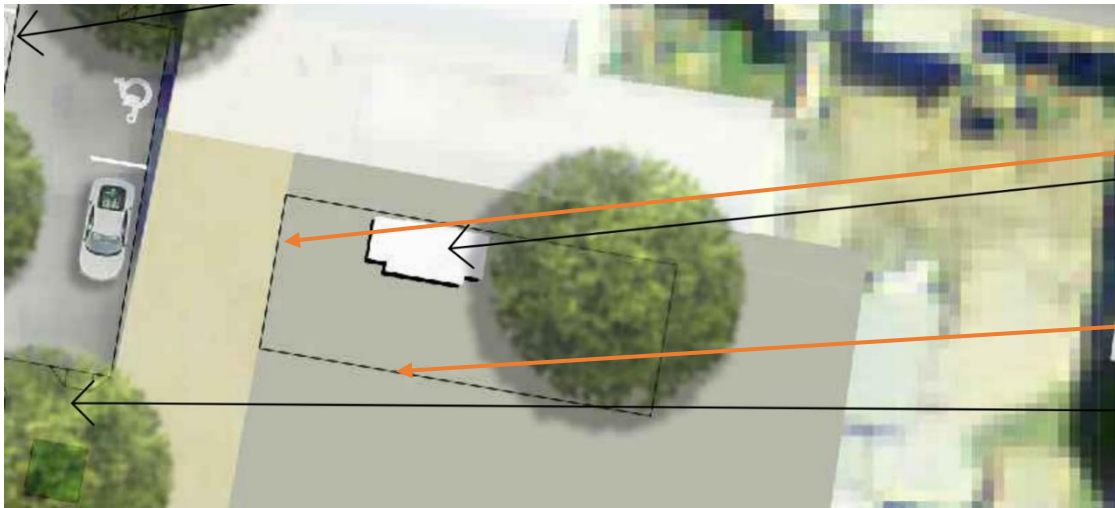

7.44m

24.71m



5m

2.8m

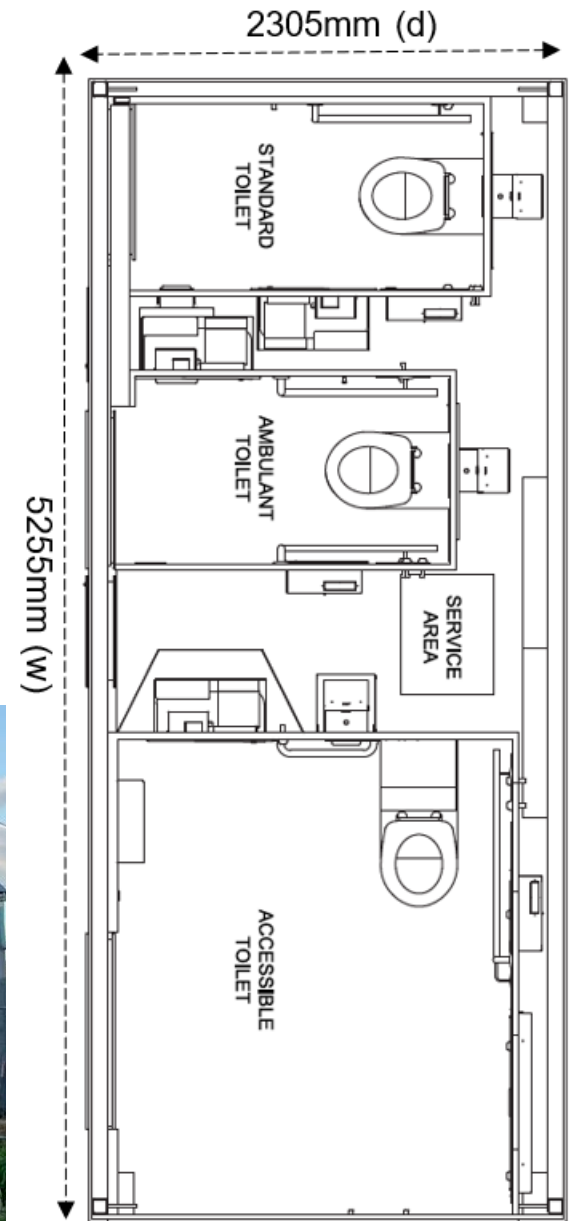

2305mm (d)

5255mm (w)

STANDARD TOILET

AMBULANT TOILET

ACCESSIBLE TOILET

SERVICE AREA



**SITE IMAGES**

